

GROUND FLOOR CLASS A OFFICE SPACE

FOR IMMEDIATE LEASE

GEORGETOWNE / MILL BASIN, BROOKLYN, NY 11234

Location

2363 RALPH AVENUE

(Between Avenue N & East 64th St.)
Brooklyn, NY 11234

Description

Class A office space for lease on the ground floor of a newly-constructed building. The space was built out and used by a financial services company and lends itself to any sales or administrative office use.

Space

2,200 rsf (20' x 110') ~ Ground Floor

The Space is configured into a waiting / reception area, a large open bullpen area, two private offices, a file storage area, a large storage room and two restrooms.

Features

- * Modern Class A Space
- * Long-Term Lease Available
- * High-Visibility Location
- * Furniture Available
- * Motivated Landlord
- * High-end Installation



Possession

Immediate Possession

Parking

On-site parking for one vehicle plus ample street parking

Transportation

Bus (B47 & Bm1) Stop on the Corner

Rent

Offered at \$70,400 / annum (\$32 / SF) NNN



Tony vanderBeek

718.887.6200

Coldwell Banker Mid Plaza Commercial Real Estate

RETAIL & OFFICE LEASING and INVESTMENT PROPERTY SALES

tony@tvbrealty.com

www.TvBRealty.com

**COLDWELL
BANKER**





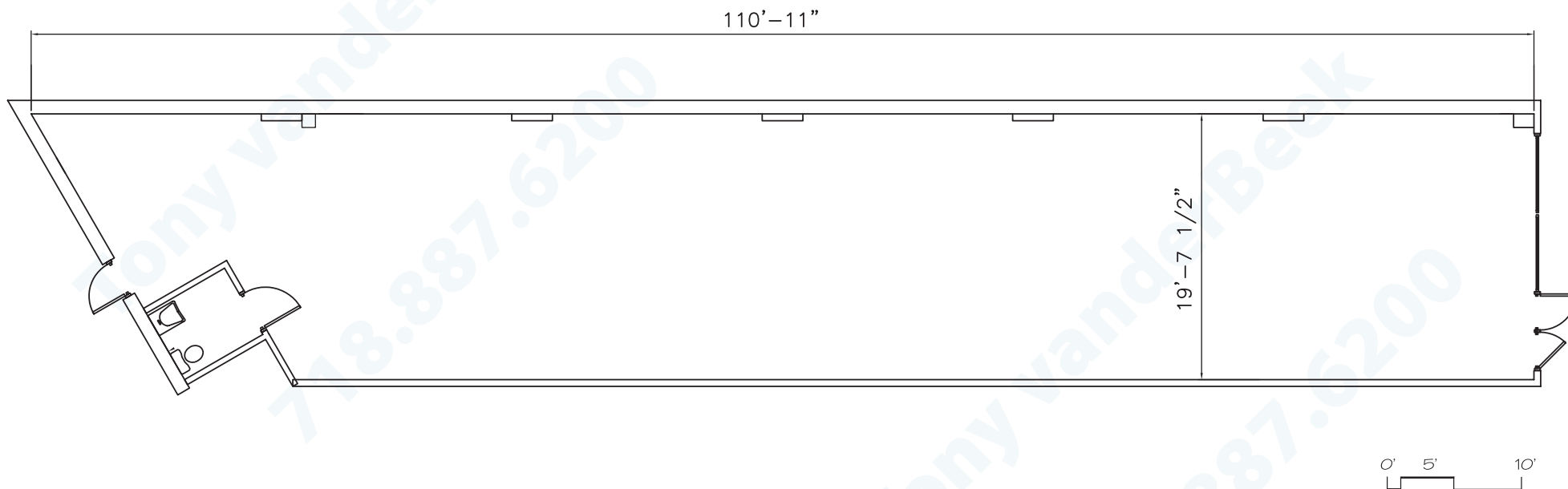

All of the information furnished has been provided to us by sources which we deem to be reliable. However, no warranty or representation is made as to the accuracy thereof.

This information is submitted subject to error, omissions, change of price or rental, change of other terms and conditions, suitable references, prior sale, lease or financing, or withdrawal without notice.

Coldwell Banker Mid Plaza Commercial Real Estate



2363 Ralph Avenue, Brooklyn, NY 11234
Floor Plan

Tony vanderBeek
718.887.6200
tony@tvbrealty.com

Copyright Tony vanderBeek